



- Strong Body Structure Against High Temperature
- ZERO and SPAN Setting
- More durable with INCONEL 718 Alloy Membrane
- High Stability
- Accurate measurement
- Insensitive to Electrical Noise
- Long life
- Different Signal Options: 4-20mA, 0-10VDC, 3.33 mV / V

They are used to measure the pressure and temperature of hot fluids in the plastics, rubber, food, etc. sectors. In this way, the quality of the production is higher and damaged due to the high pressure is provided to the machine.

The MPT series are low cost and high quality products. The MPT makes mercury measurements in the series. In products in the health and food sector, oily measurements are made.

EPA Series Digital Measuring and Control Devices are also available with the measured value being displayed.

Technical Specifications

Pressure Range	0-350BAR , 0-500BAR , 0-700BAR , 0-1000BAR (Optional between 35BAR and 2000BAR)
Output Signals	4-20mA , 0-10VDC 3,33 mV/V , 2 mV/V
Supply Voltage	24VDC, for 4-20mA/0-10V output models 10VDC, for mV/V output models
Max. Temperature	350°C -662°F
Max. Pressure	1,5 x FS
Accuracy	±0,5% FS
Repeatability	±0,2% FS
Internal Calibration Signal	80% FSO ±1.0%FSO
Thermocouple	-
Electrical Connection	6 pin socket
Process Connection	½ -20 UNF standard (Optional M14x1.5, M18x1.5) Mounting torque value : 30Nm
Body	Stainless Steel
Membrane Material	Inconel 718 (Chrome-Nickel Alloy)
Protection Class	IP 65
Zero shift due to temperature change	1,72BAR (25PSI) / 38°C (100°F)
Other	Zero and Span Settings (except "3,33 mV" model)

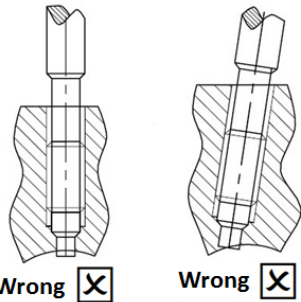

One thing to note during installation is that the extreme part of the sensor, which is the pressure measuring part, is not damaged during installation. If this part is damaged, the sensor will not measure.

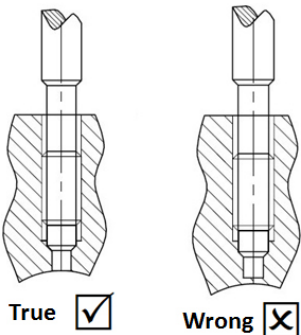

Order Details

Model No

MPT - 112 - 350bar - 1/2 - V

Pressure Range

350Bar : 0...350Bar
500Bar : 0...500Bar
700Bar : 0...700Bar
1000Bar : 0...1000Bar

Output Signal

V : 0-10VDC
mA : 4-20mA
mV : 3,33mV/V

Recommended Accessories
Process Control Devices 'EPA Series'



6 pin socket

Body Material

112: Rigid Body

Mechanical Connection

½ : ½"20 UNF
M14 : Metric 14 (M14 x 1,5)



Electrical Connections

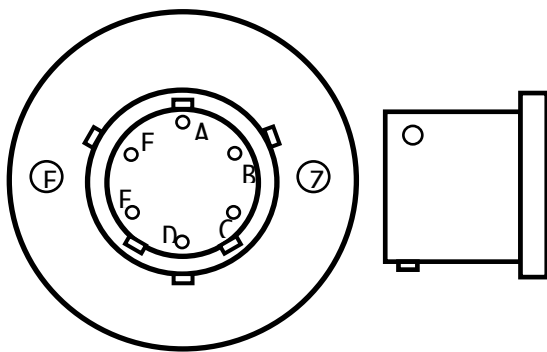

3,33mV/V or 2,00mV/V Analog Output

A : +Signal Out B : -Signal Out
 C : +Supply Voltage +10VDC D : -Supply Voltage GND
 E,F : Calibration (FS %80)

0-10VDC Analog Output

A : +Signal Out (0 - 10VDC) B : -Signal Out
 C : +Supply Voltage +24VDC D : -Supply Voltage GND
 E,F : Calibration (FS %80)
 Z : Zero S : Span

4-20mA Analog Output (2 Wire Connection)

A : + Supply Voltage 24 VDC B : - Signal(4-20mA Output)
 E,F : Calibration (FS %80)
 Z : Zero S : Span

Mechanical Dimensions

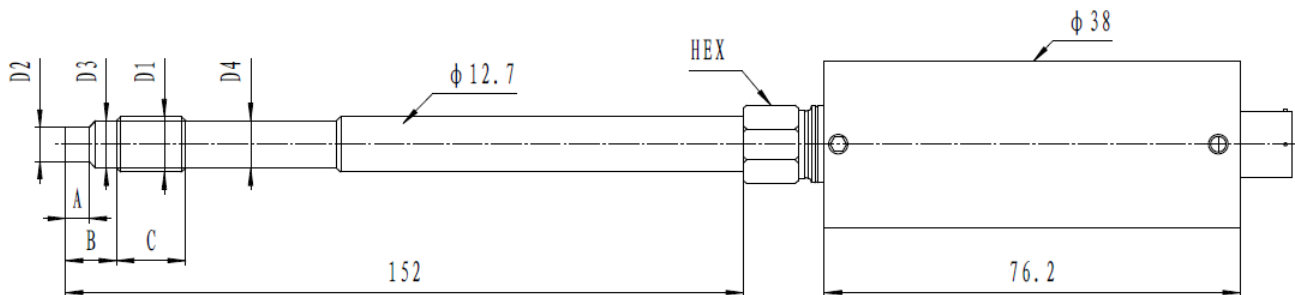

D1	D2	D3	D4	A	B	C	HEX	HEX 2
1/2-20UNF	$\phi 7.8^{+0.02}_{-0.06}$	$\phi 10.5$	$\phi 10.8$	5.44	11.5	16	16	22
M14 × 1.5	$\phi 7.8^{+0.02}_{-0.06}$	$\phi 11.5$	$\phi 11.8$	5.44	11.5	16	16	22